

LOCATION PLAN
(SCALE 1:20000)
POST CODE: LL17 0AY
NGR(E:306943, N:372700)

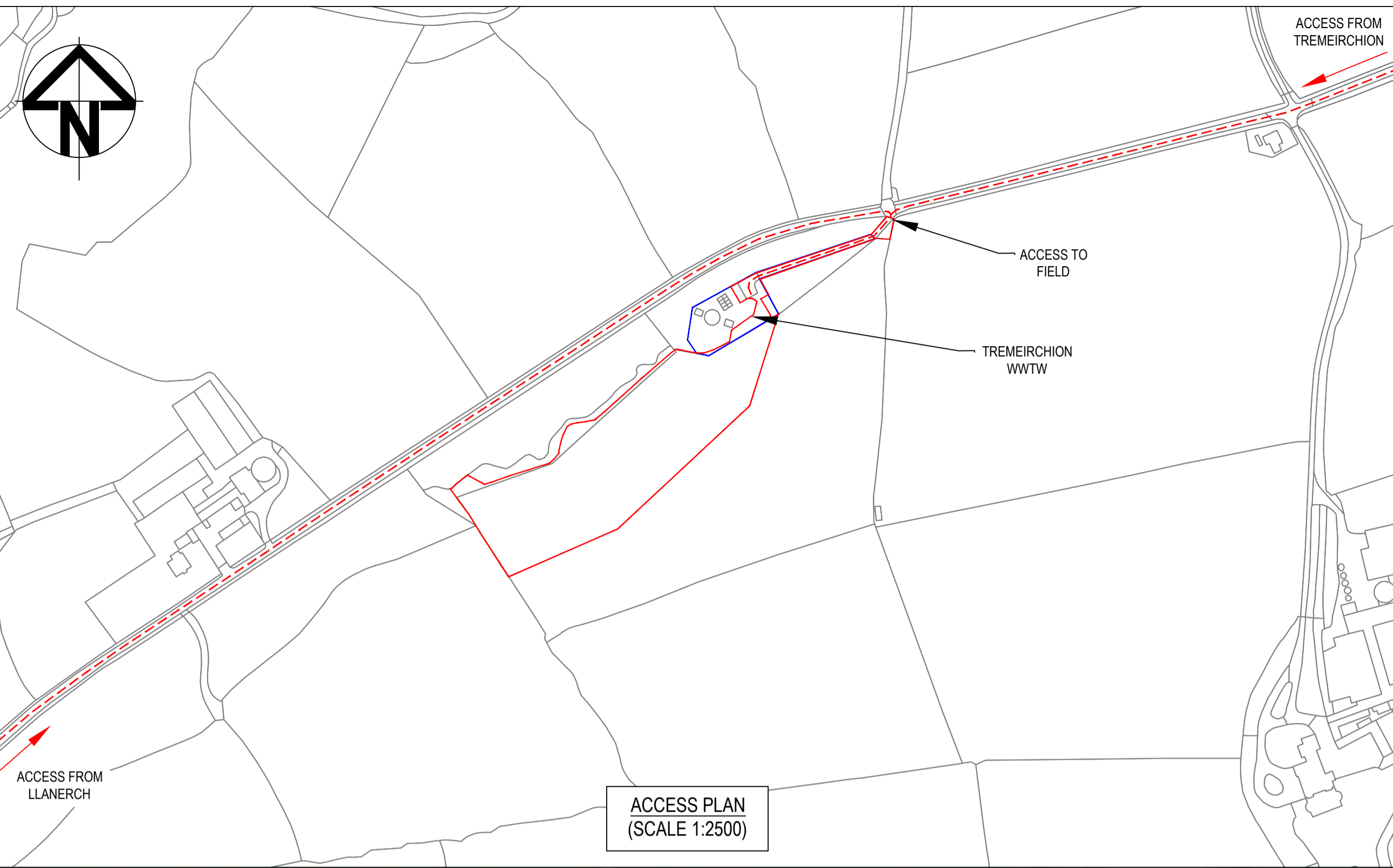

ACCESS PLAN
(SCALE 1:2500)

DRAWING DETAIL IS INDICATIVE AND ISSUED FOR INFORMATION PURPOSES ONLY.

NOTES:
1. DRAWING TO BE READ IN CONJUNCTION WITH SCHEME REGISTER, DOCUMENT REFERENCE B17505-00DM13-03-AB-RG-CA-DH0013 TO ESTABLISH ALL SUPPORTING INFORMATION.



SITE LAYOUT
(SCALE 1:1000)

NEAREST POST CODE: LL17 0AY
NGR: (E:306943, N:372700)
WHAT3WORDS: //SCAR.BLOOM.OUTNUMBER

KEY:
GREY - EXISTING EQUIPMENT/STRUCTURES
DASHED RED - SITE ACCESS
DASHED BLUE - EXISTING DCWW BOUNDARY
DASHED RED - PLANNING APPLICATION BOUNDARY

11.1	21/09/23	MC	BOUNDARY AMENDMENT	ZJ	RT	RT	16/10/24
11.0	21/09/23	MC	FOR INFORMATION	ZJ	RT	RT	30/05/24
Rev.	Date	Drawn	Description	Rvd.	Chkd.	Appd.	Date



Ty Awen, Spooner Close, Coed Kernow, Newport, NP108FZ

Project Name: TREMEIRCHION INTEGRATED CONSTRUCTED WETLAND TRIAL

Drawing Title: SITE LOCATION

Suitability: FOR INFORMATION S2

Originator: M. CARTER Designer: Z. JANAS Date: 16/10/24

Internal Project Number: 17505 Scale: AS SHOWN AT A1 Rev: 11.1

Drawing Number: B17505-00DM13-03-AB-DR-CA-CI5000

